

FORM No. 1.

The following are the Courses and Distances Up the River.

- S. 57 W. 18
- N. 85 W. 28
- N. 68 W. 34
- N. 83 W. 14
- N. 64 W. 34
- N. 53 W. 14
- N. 65 W. 16
- N. 76 W. 104
- West 26
- N. 72 W. 87
- N. 44 W. 14
- N. 78 W. 37
- S. 70 W. 26
- S. 63 W. 13
- S. 52 W. 13
- S. 34 W. 8
- S. 3 W. 14
- S 12 E. 7
- S 32 E. 10
- S. 45 E. 35
- S. 21 E. 22
- S 4 E. 26

600 Total

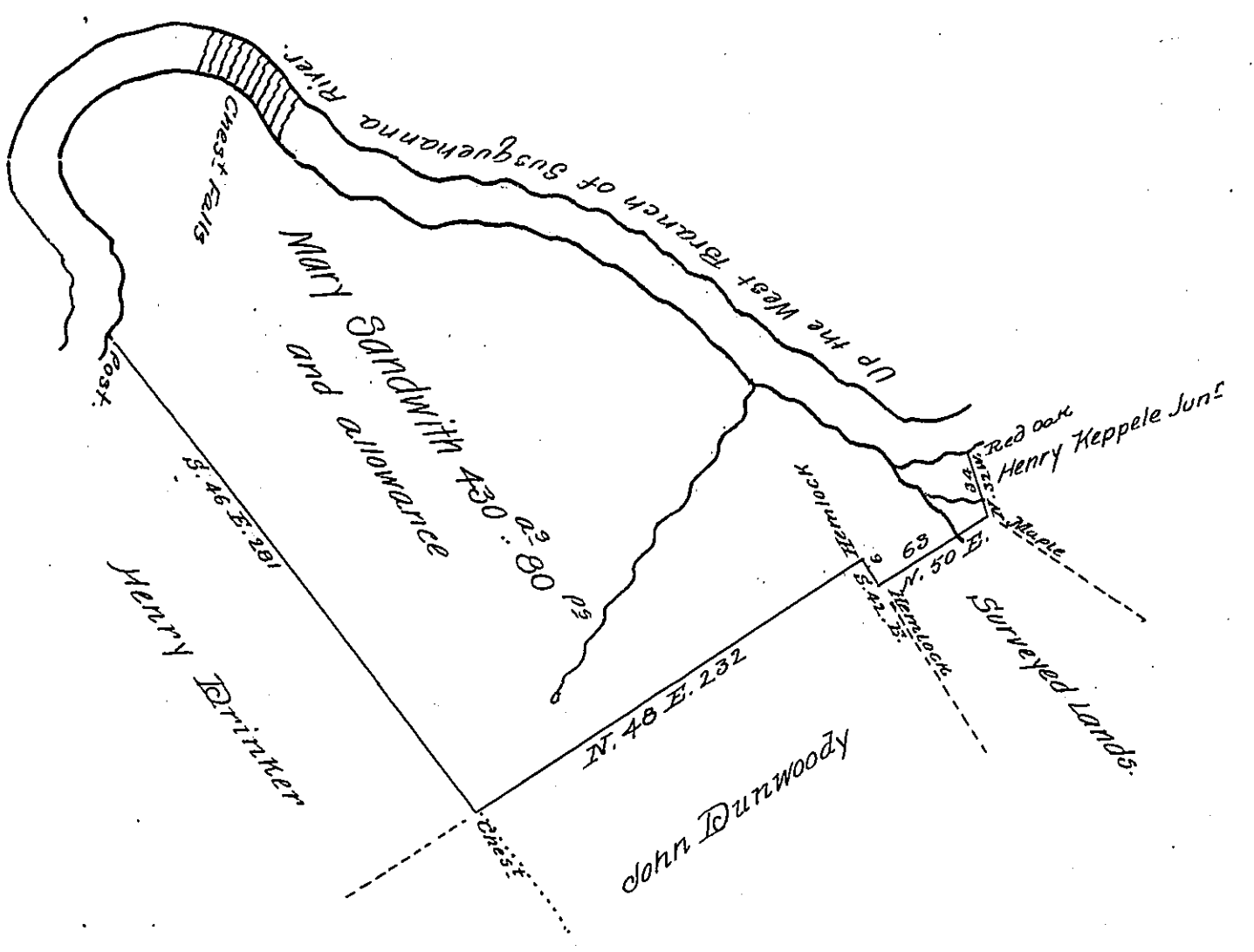

Situate on the south side of the West Branch of Susquehanna River, about two Miles below the Mouth of Chest Creek, in Allegheny Township Huntingdon County, containing four hundred and thirty acres, Eighty perches and the usual allowance for Roads Surveyed the 3rd Day of September 1800 for Mary Sandwith, in pursuance of her Warrant dated the 10th day of January 1800.

John Canan, D. S.

To Samuel Cochran, Esq.
Surveyor General of Penns^a.

IN TESTIMONY that the above is a copy of the original remaining on file in the Department of Internal Affairs of Pennsylvania, made conformably to an Act of Assembly approved the 16th day of February 1833, I have hereunto set my hand and caused the Seal of said Department to be affixed at Harrisburg, this eleventh day of January 1907

Isaac D. Brown
Secretary of Internal Affairs.